

ICONIC SPACES ALL IN ONE DESTINATION





STRATEGIC LOCATION OFFERS UNMATCHED ACCESSIBILITY

Cinnamon Life at City of Dreams Sri Lanka is South Asia's premier meeting and event destination. Strategically located in the heart of Colombo, Sri Lanka, it is a **40 minute drive from the airport**, making it highly accessible for international and local guests alike. Situated in close proximity to popular cultural and leisure spots, Cinnamon Life offers unparalleled convenience and luxury.

With its state of the art facilities, versatile event spaces, and breathtaking views, Cinnamon Life ensures that your events are not only seamless but also memorable. Whether you're hosting a business conference, a trade show, or a cultural event, Cinnamon Life at City of Dreams is the ultimate all in one destination to meet your needs and exceed your expectations.



LOCATION MAP

NAVIGATING YOUR PREMIER DESTINATION



Each floor houses state of the art meeting spaces, designed for flexibility and innovation. Equipped with the latest technology, these venues cater to a variety of events, from intimate meetings to large scale conferences. Versatility is key, with rooms adaptable to specific needs. Embrace the power of modern technology in settings that inspire creativity and foster productivity.

LEGEND

- Hotel
- Apartment Towers
- Offices
- Cumulus Ballroom
- Celestine Ballroom
- Entrance Ramp Drop Off
- Events Lobby Drop Off
- Nüwa Lobby Drop Off
- Rooms Lobby Drop Off
- Parking
- Casino
- The Podium
- Mall
- Infinity Pool Deck
- Family Pool
- Taxi Stand



COMPREHENSIVE FLOOR BREAKDOWN

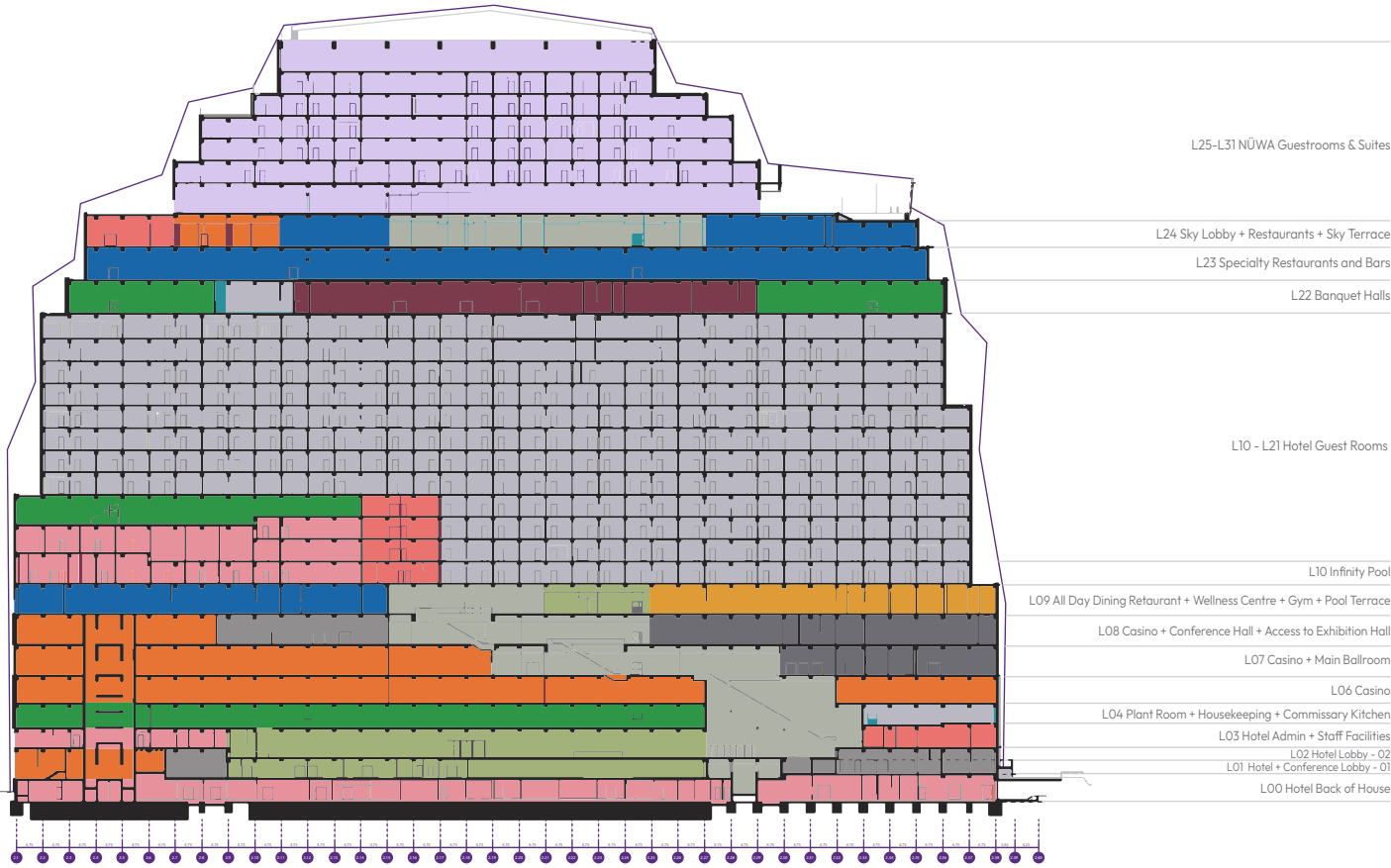

L25-L31 NÜWA Guestrooms & Suites

L24 Sky Lobby + Restaurants + Sky Terrace

L23 Specialty Restaurants and Bars

L22 Banquet Halls

L10 - L21 Hotel Guest Rooms

L10 Infinity Pool

L09 All Day Dining Restaurant + Wellness Centre + Gym + Pool Terrace

L08 Casino + Conference Hall + Access to Exhibition Hall

L07 Casino + Main Ballroom

L06 Casino

L04 Plant Room + Housekeeping + Commissary Kitchen

L03 Hotel Admin + Staff Facilities

L02 Hotel Lobby - 02

L01 Hotel + Conference Lobby - 01

L00 Hotel Back of House

- LEGEND**
- | | | | |
|--------------------|---------------------|---------------------|----------------------------|
| Nüwa Guest Rooms | F&B Back of House | Exhibition | Service Bay |
| Guest Rooms | Hotel Back of House | Staff Facilities | Hotel + Conference Entries |
| VIP Sky Lobby | Sales Centre | Casino | Washrooms |
| Sky Lobby | Banquet | Gym+Wellness Centre | Hotel + Meeting Rooms |
| F&B Front of House | Main Ballroom | Plant | Hotel Circulation |



STAY

Cinnamon Life is home to a collection of 687 elegant rooms and suites, designed to immerse guests in absolute comfort. Each room offers awe inspiring views of the Indian Ocean, Beira Lake, or Colombo City.

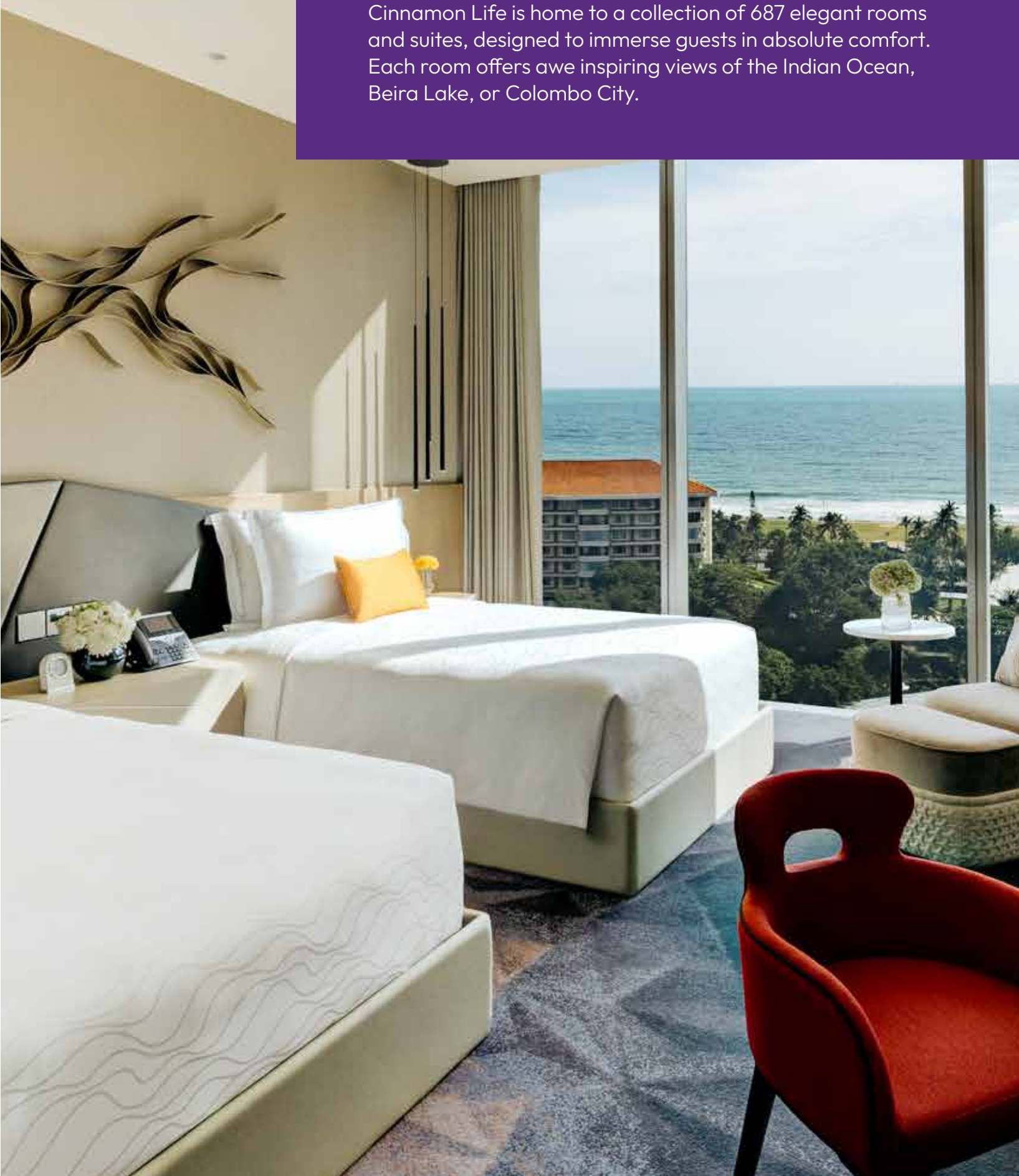

ROOM TYPES

TOTAL

Premier Life, King Rooms	399 Rooms
Premier Life, Twin Rooms	251 Rooms
Oceanscape Suite	26 Suites
Skyline Suite	11 Suites

SERVICES & FACILITIES

- 24 Hour Concierge Service
- 24 Hour In Room Dining
- 24 Hour All Day Dining Restaurant
- Kids Club
- Accessible Amenities
- 2,500 Parking Spaces
- 3 Lobbies

RECREATION

- Mall Direct Access
- 24 Hour Fitness Centre
- 2 Outdoor Pools
- Wellness Centre including a Vitality Pool
- Curated City Experiences
- Immersive Local Art Experiences

MEETING SPACES BY FLOOR: VERSATILE AND HIGH TECH

Cinnamon Life offers a multitude of options for events comprising 11 versatile venues, spreading across 160,000 sq. ft. This collection includes five ballrooms and six outdoor spaces, with a capacity to host up to 5,000 guests. These spaces are enhanced by natural daylight and are fully equipped with the latest technological advancements, including 5G readiness, LED pillars, modern AV systems, and customisable LED ceilings. The design of each space prioritises privacy and exclusivity, featuring dedicated pre function areas for personalised delegate experiences.

Unique to Cinnamon Life are four dedicated entrance lobbies, including one specifically for events, allowing for a customisable branding opportunity that enhances the guest arrival and departure experience. Facilitating seamless movement throughout the venue, the resort has 83 elevators and 10 escalators, alongside a parking capacity for 2,500 vehicles, ensuring easy access to event spaces, accommodations, and dining options.

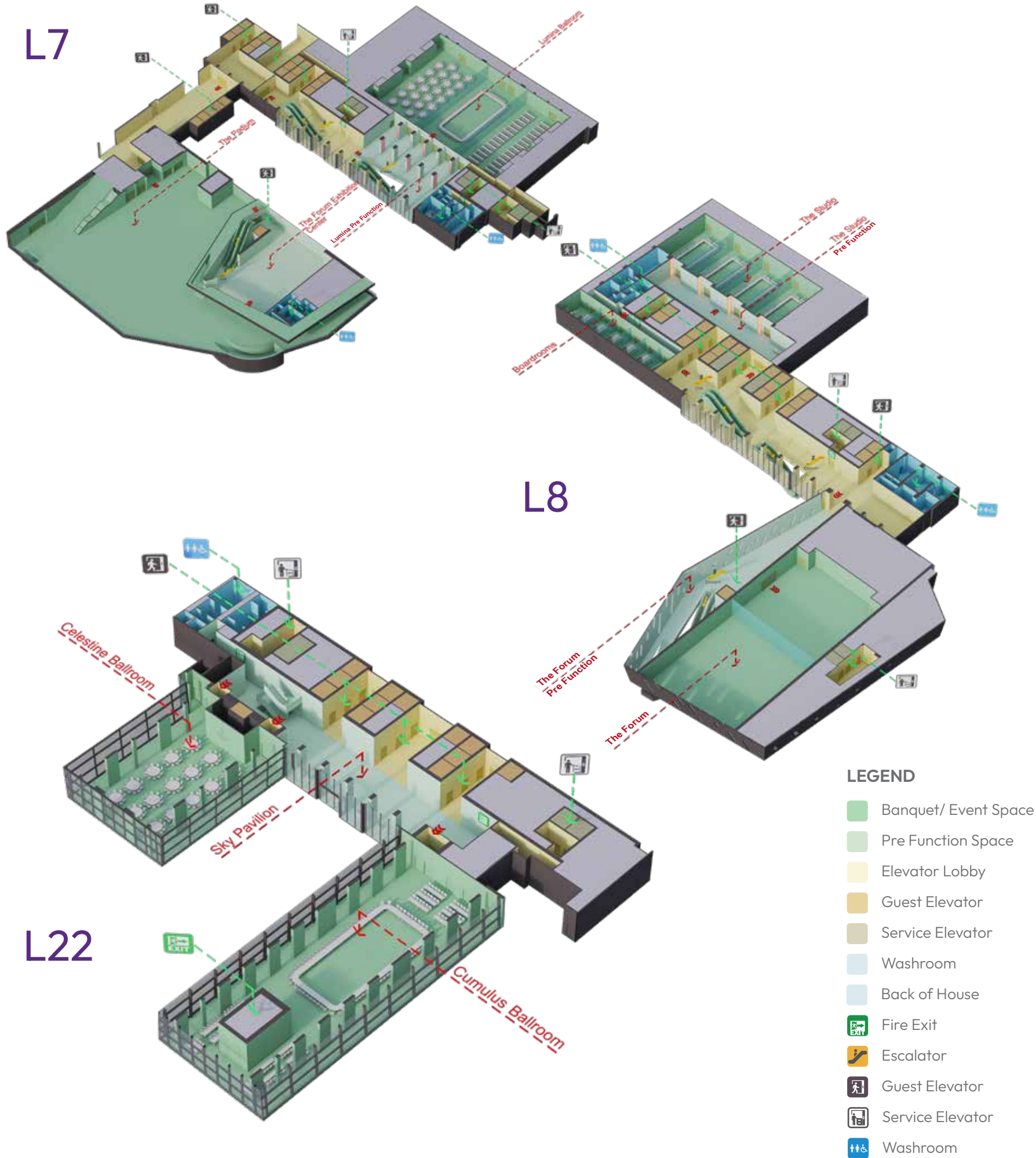

LEVEL

07

LUMINA
BALLROOM

- Pillarless Space:** Enjoy an unobstructed event area for maximum flexibility and visibility.
- Partitionable by Three:** Easily divide the space into three sections using electronic dropdown partitions.
- Pre Function Area:** Enhanced with 9 LED pillars for a dynamic and engaging atmosphere.
- LuxLight® Chandeliers:** Featuring multi coloured simulation LED chandeliers with 2,500 colour combinations and 84 focus track light beams for versatile lighting options.



Area		Dimensions	
Sq. Ft	Sq. M	Feet	Metres
15,112	1,403	156.17 x 102.13 x 20.3	47.6 x 31.12 x 6.18

LEGEND

- Banquet/ Event Space

Pre Function Space

Elevator Lobby

Guest Elevator

Service Elevator

Washroom

Back of House

Fire Exit

Escalator

Guest Elevator

Service Elevator

Washroom

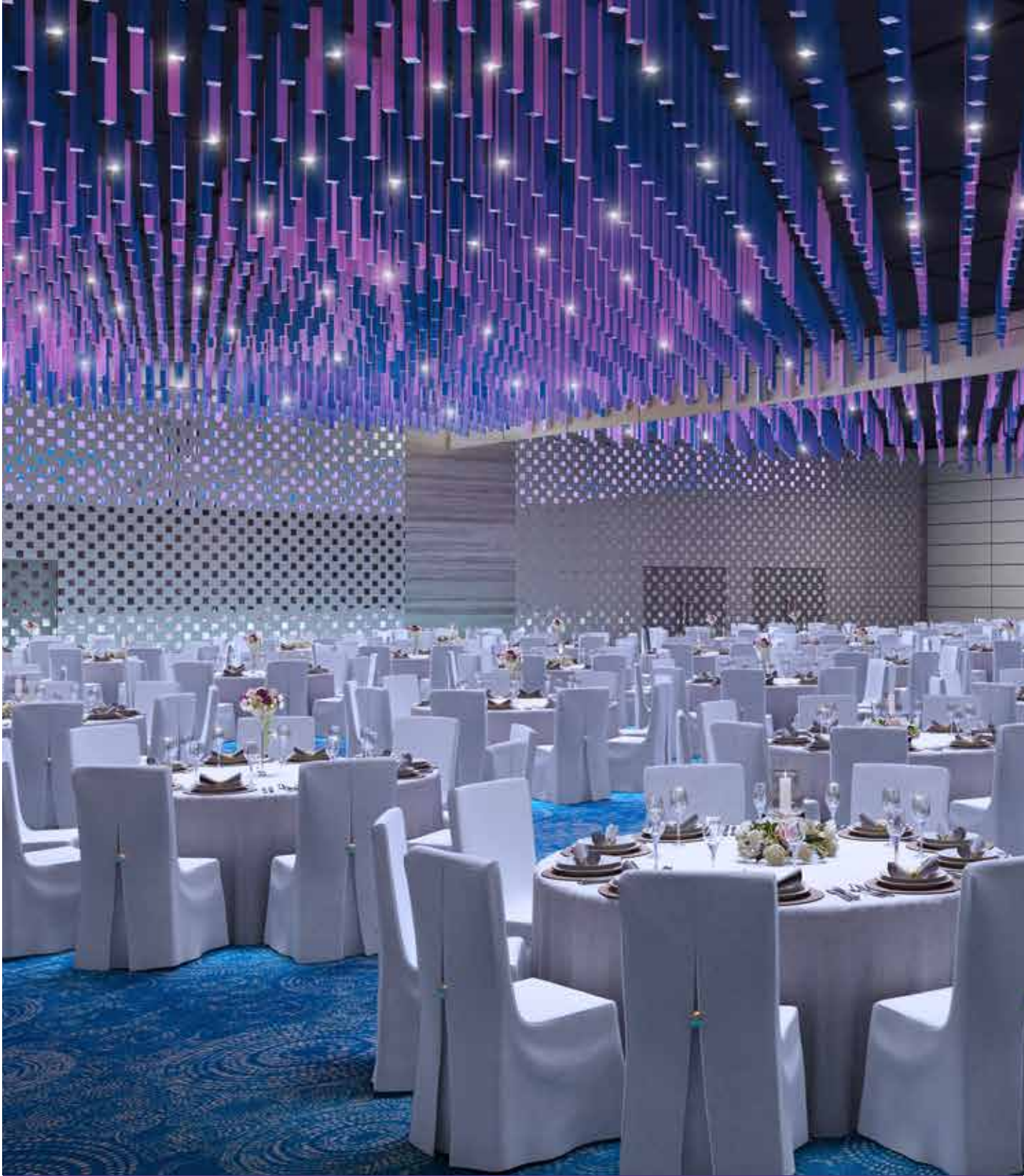

Name	Seating Capacity
Theatre	1860
Banquet	1040
Boardroom	132
Classroom	924
Cocktail	1134
Cluster	728

LEVEL

07

THE
PODIUM

Convenient Access: Direct entry from the entrance ramp and parking space.

Scenic Views: Enjoy stunning views of the Indian Ocean and Beira Lake.

Open Layout: Spacious pillarless design for maximum flexibility and unobstructed views.



Area		Dimensions	
Sq. Ft	Sq. M	Feet	Metres
25,783	2,395	125 x 174 x Open Air	38.10 x 53.03 x Open Air

LEGEND

- Banquet/ Event Space
- Pre Function Space
- Elevator Lobby
- Guest Elevator
- Service Elevator
- Washroom
- Back of House
- Fire Exit
- Escalator
- Guest Elevator
- Service Elevator
- Washroom

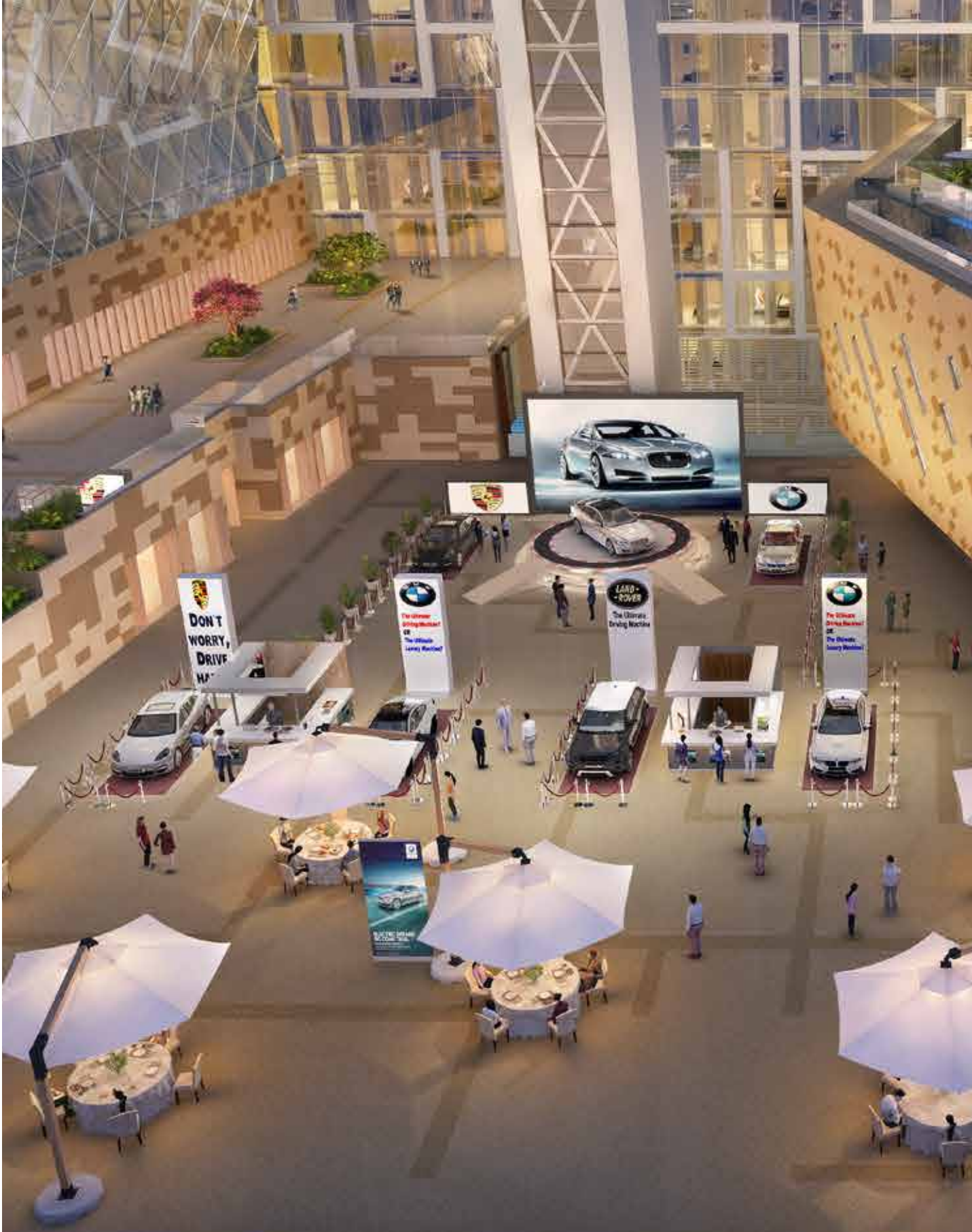

Name	Seating Capacity
Banquet	1300

LEVEL

07

THE FORUM - EXHIBITION CENTRE

- Pillarless Space:** Enjoy an open, unobstructed area perfect for any event setup.
- Direct Access:** Easily reach The Forum and The Podium from this space.
- Natural Daylight:** Benefit from abundant natural light, creating a bright and welcoming atmosphere.



Area		Dimensions	
Sq. Ft	Sq. M	Feet	Metres
6,680	620	88 x 60.11 x 13	26.82 x 18.32 x 3.99

LEGEND

Banquet/ Event Space

Pre Function Space

Elevator Lobby

Guest Elevator

Service Elevator

Washroom

Back of House

Fire Exit

Escalator

Guest Elevator

Service Elevator

Washroom



Name	Seating Capacity
Cocktail	450

LEVEL

08

THE FORUM

- Pillarless Space:

Enjoy a wide, unobstructed area ideal for various event setups.
- Flexible Partitioning:

Can be divided into two sections using electronic dropdown partitions.
- Soundproof Venue:

Ensures a quiet and controlled environment for all events.

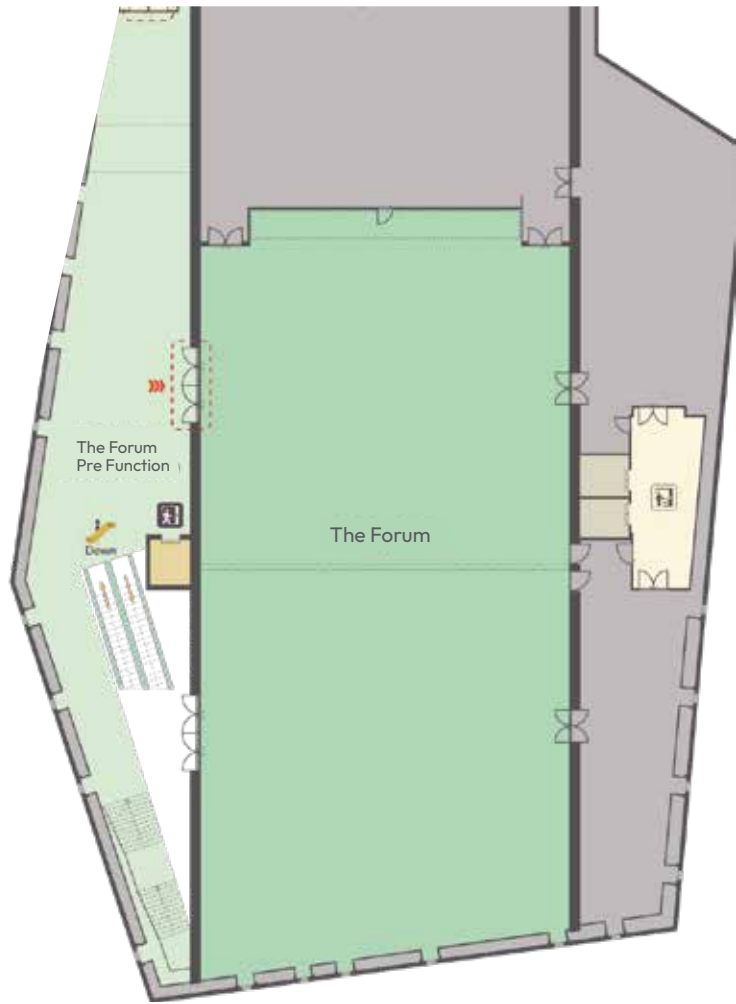

Area		Dimensions	
Sq. Ft	Sq. M	Feet	Metres
10,771	1,000	141.21 x 75.84 x 21.3	43.04 x 22.56 x 6.49

LEGEND

Banquet/ Event Space

Pre Function Space

Elevator Lobby

Guest Elevator

Service Elevator

Washroom

Back of House

Fire Exit

Escalator

Guest Elevator

Service Elevator

Washroom

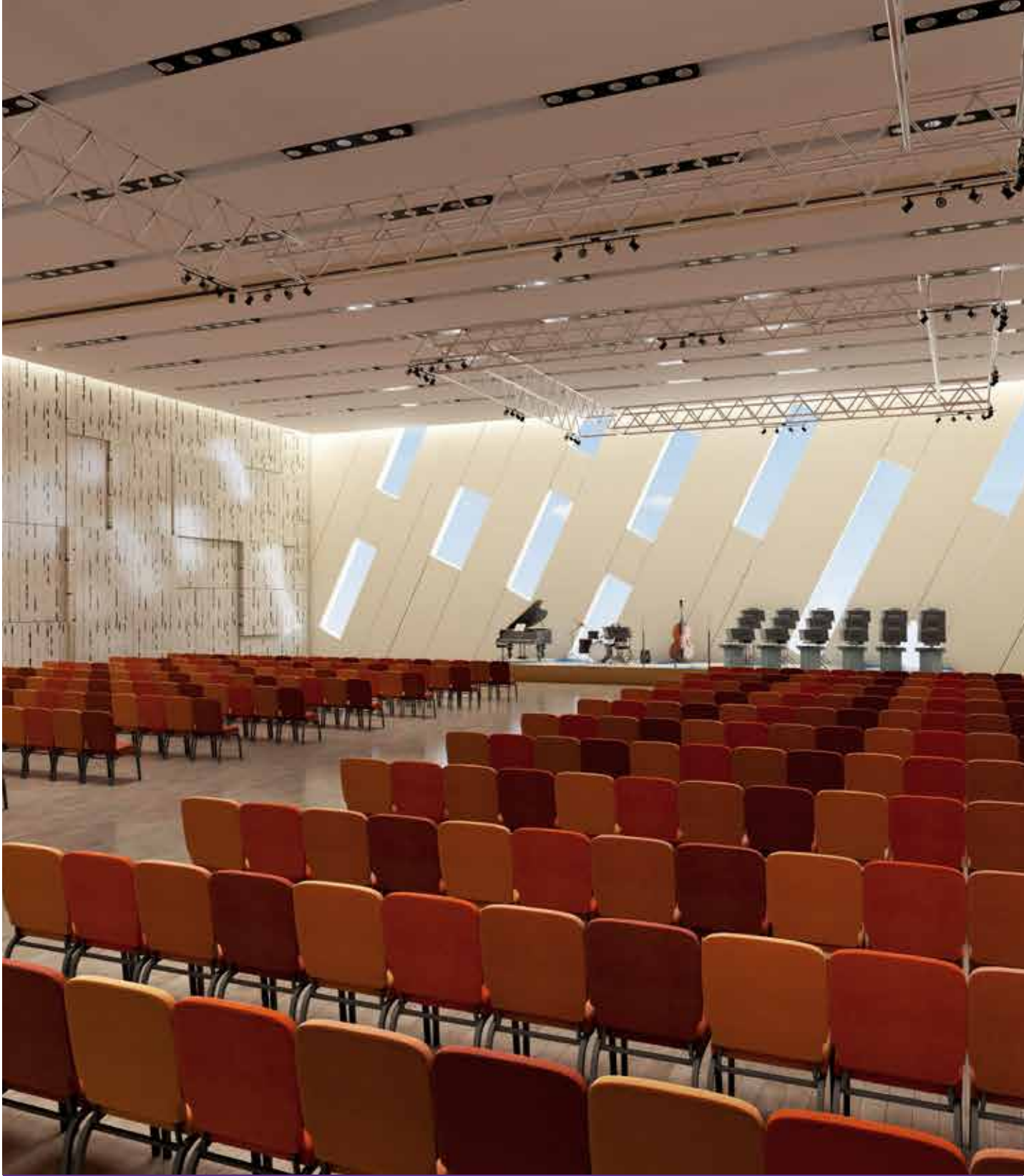

Name	Seating Capacity
Classroom	690
Banquet	670
Theatre	1280
Cocktail	798
Cluster	469



LEVEL

08

THE

STUDIO

Pillarless Space: Enjoy an expansive, unobstructed area ideal for versatile event setups.

Flexible Partitioning: Easily divide the space into four sections with electronic sliding partitions for tailored configurations.

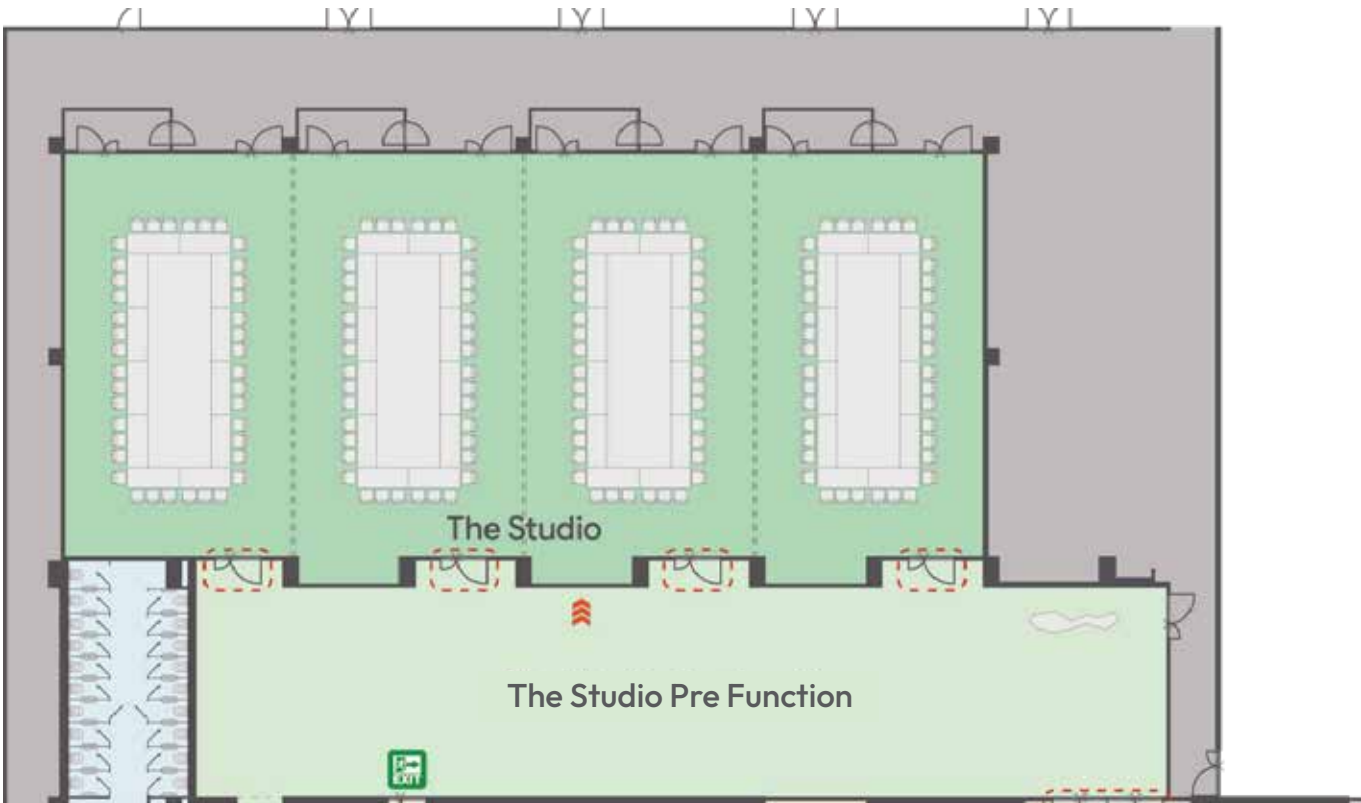

Area		Dimensions	
Sq. Ft	Sq. M	Feet	Metres
6,201	576	122.38 x 51.04 x 12.43	37.30 x 15.56 x 3.79

LEGEND

- Banquet/ Event Space
- Pre Function Space
- Elevator Lobby
- Guest Elevator
- Service Elevator
- Washroom
- Back of House
- Fire Exit
- Escalator
- Guest Elevator
- Service Elevator
- Washroom



Name	Seating Capacity
Theatre	783
Banquet	380
Classroom	399
Cocktail	408
Cluster	266
Boardroom	114

LEVEL

08

BOARDROOMS

- Pillarless Space:** Enjoy a vast, unobstructed area perfect for versatile event setup.
- Flexible Partitioning:** Easily divide the space into six sections with electronic sliding partitions for customised configurations.
- Convenient Adjacency:** Located next to The Studio (Level 08), making it ideal for breakout rooms and additional event spaces.

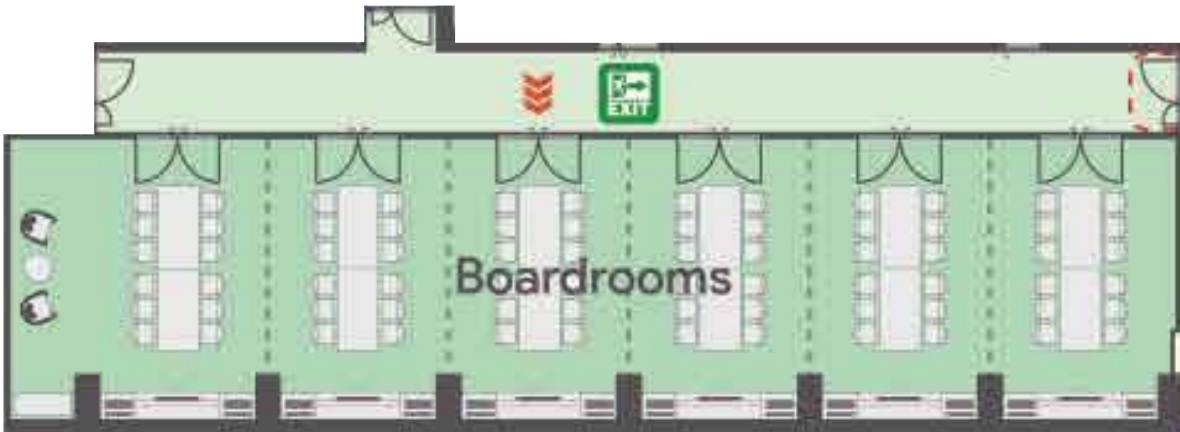

Area		Dimensions	
Sq. Ft	Sq. M	Feet	Metres
2,029	188	100 x 19.46 x 12.8	30.54 x 5.93 x 3.9

LEGEND

Banquet/ Event Space

Pre Function Space

Elevator Lobby

Guest Elevator

Service Elevator

Washroom

Back of House

Fire Exit

Escalator

Guest Elevator

Service Elevator

Washroom



Name	Seating Capacity
Theatre	639
Boardroom	90
Classroom	102
Banquet	90
Cluster	56

LEVEL

22

CELESTINE
BALLROOM

- Natural Daylight:** Enjoy ample natural light for a bright and welcoming atmosphere.
- Panoramic Views:** Marvel at 270° views of the Indian Ocean, Beira Lake, and Colombo City.
- Cantilever Ballroom:** One of two elevated 100 meters high, creating a breathtaking midair floating presence.

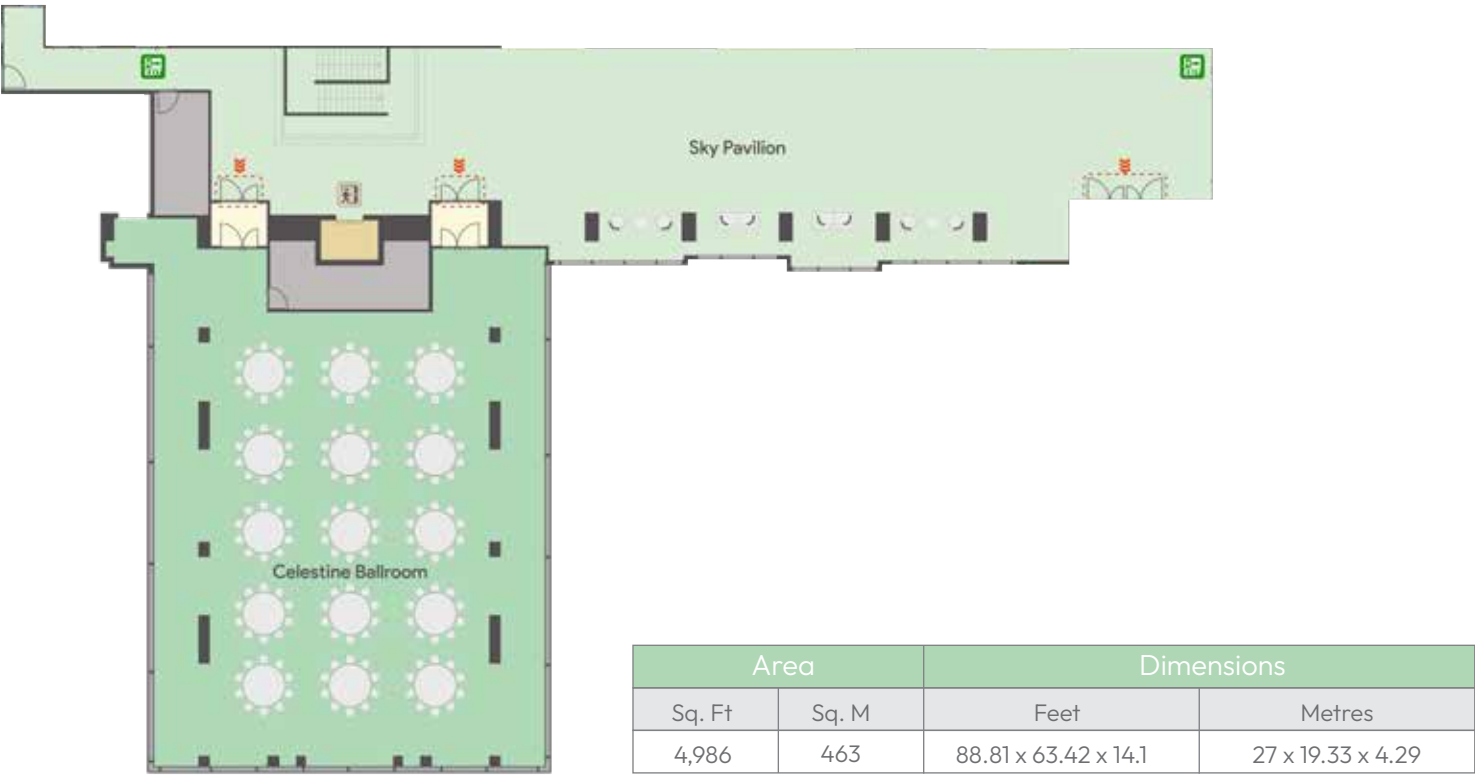

LEGEND

Banquet/ Event Space

Pre Function Space

Elevator Lobby

Guest Elevator

Service Elevator

Washroom

Back of House

Fire Exit

Escalator

Guest Elevator

Service Elevator

Washroom

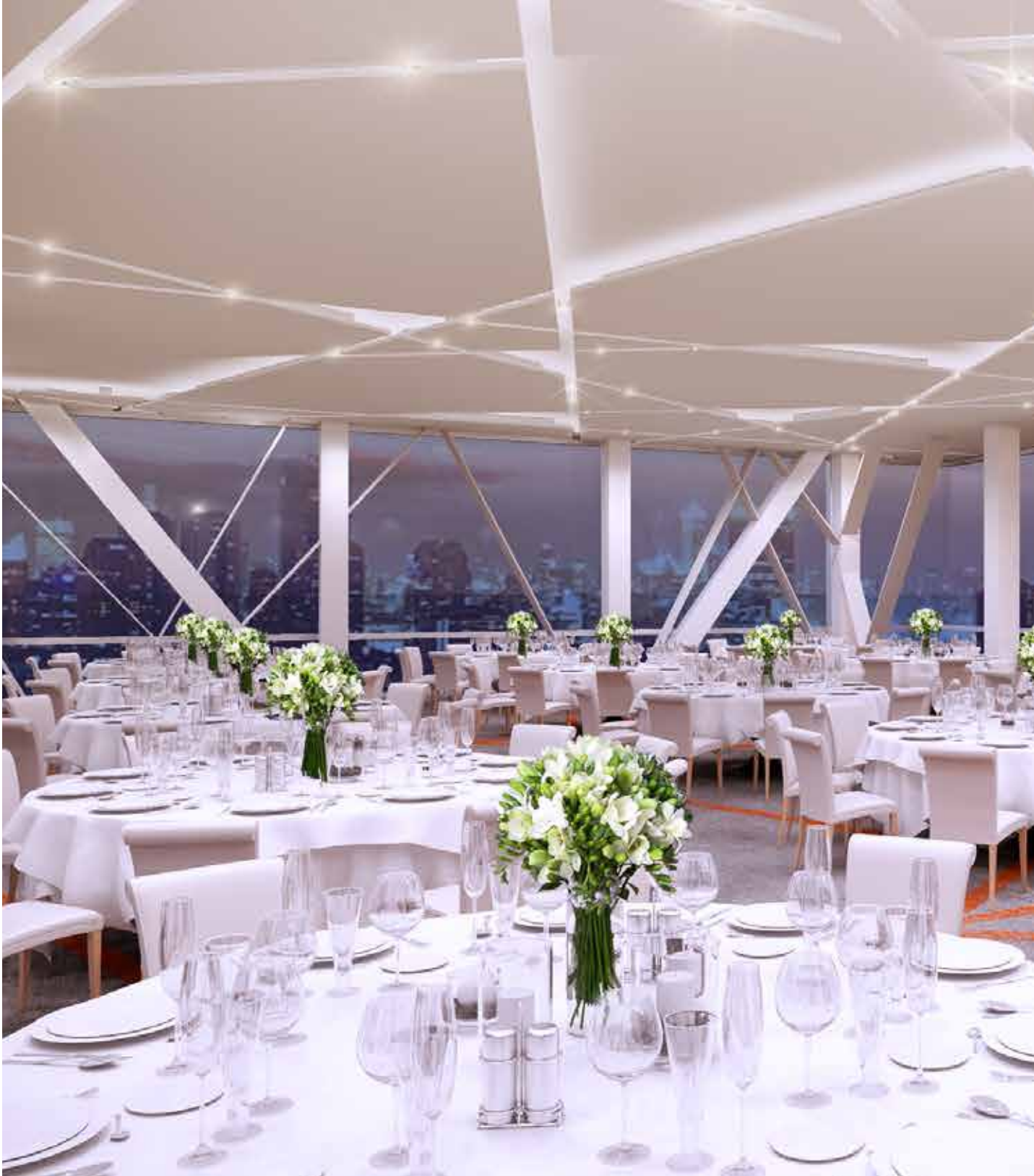

Name	Seating Capacity
Theatre	364
Banquet	220
Classroom	210
Cocktail	246
Cluster	220
Boardroom	60

LEVEL

22

CUMULUS
BALLROOM

- Natural Daylight:** Enjoy abundant natural light for a bright and inviting atmosphere.
- Panoramic Views:** Take in stunning 270° views of the Indian Ocean, Beira Lake, and Colombo City.
- Unique Cantilever Ballroom:** One of two cantilever ballrooms, elevated 100 meters high, creating a breathtaking midair floating presence.

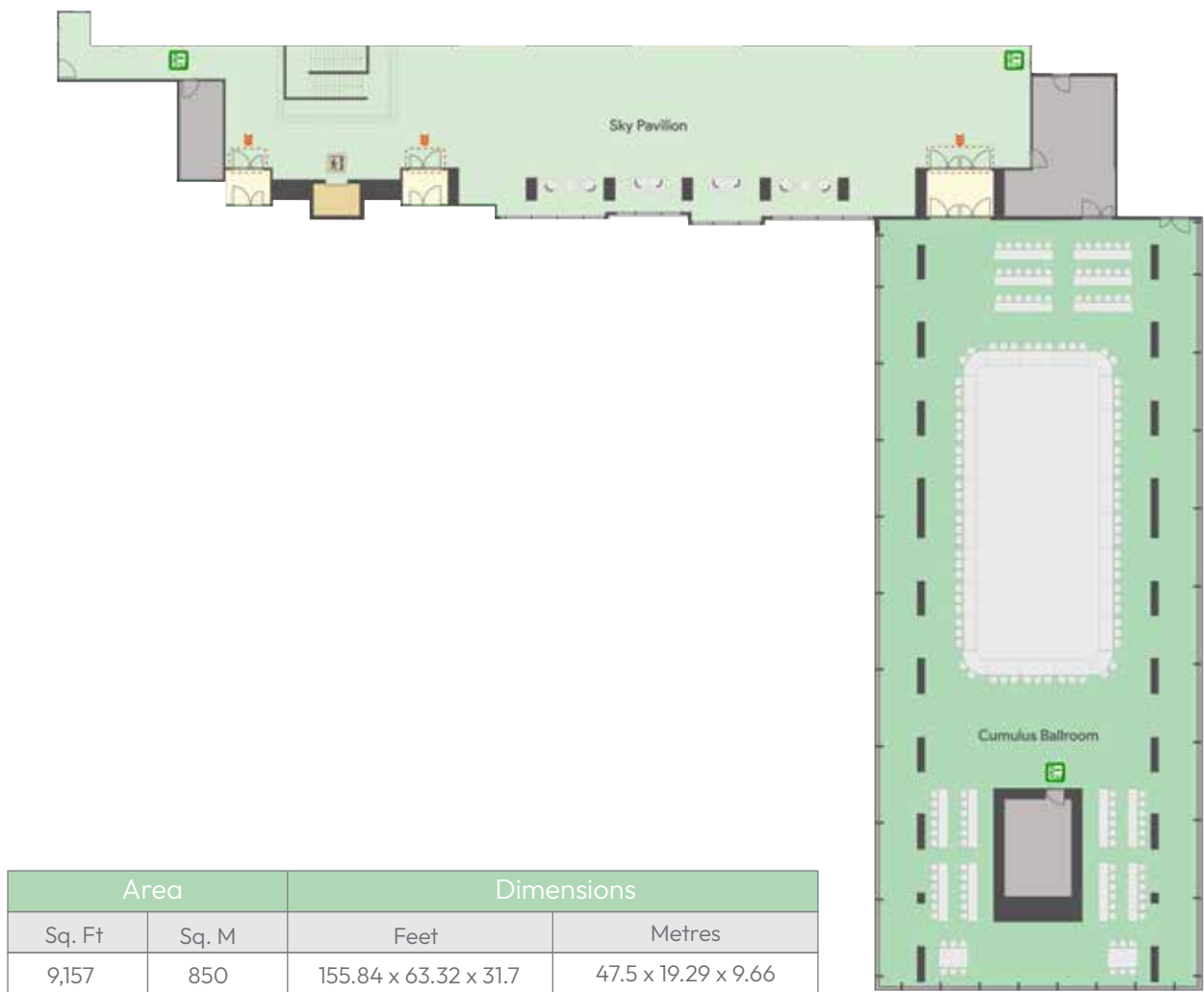

LEGEND

Banquet/ Event Space

Pre Function Space

Elevator Lobby

Guest Elevator

Service Elevator

Washroom

Back of House

Fire Exit

Escalator

Guest Elevator

Service Elevator

Washroom

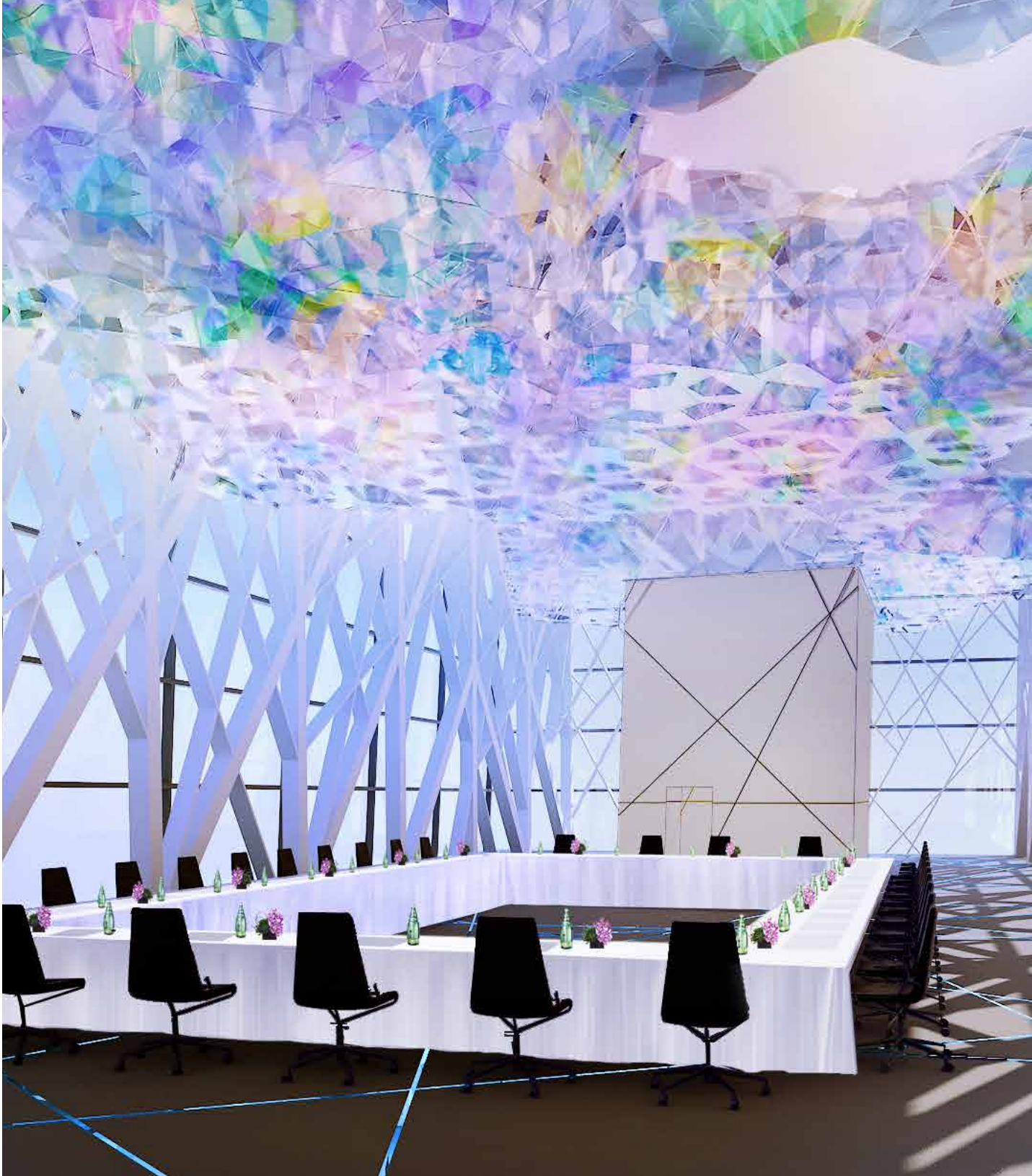

Name	Seating Capacity
Theatre	718
Banquet	410
Classroom	384
Cocktail	456
Cluster	410
Boardroom	102



LEVEL
24 SKY LOUNGE

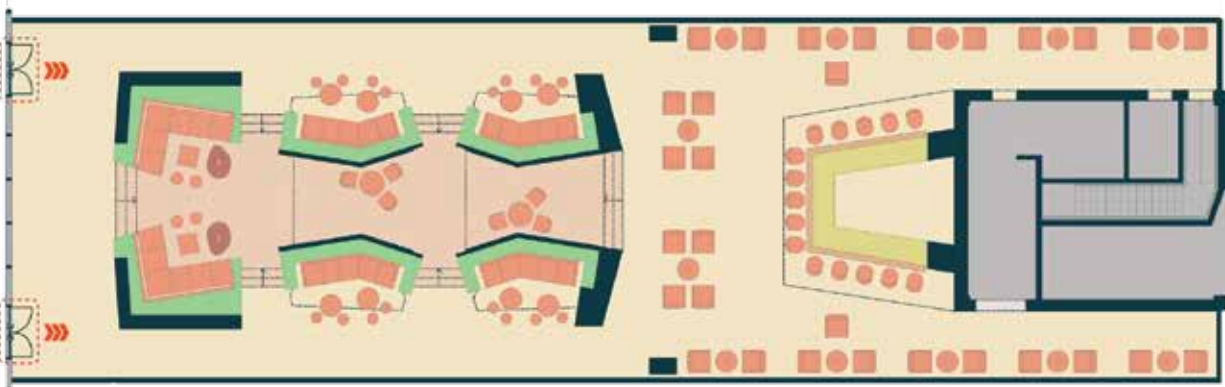

Area		Height	Lounge Seating
Sq. Ft	Sq. M		
5170	480	Open Air	106

LEVEL
09 GARDEN TERRACE

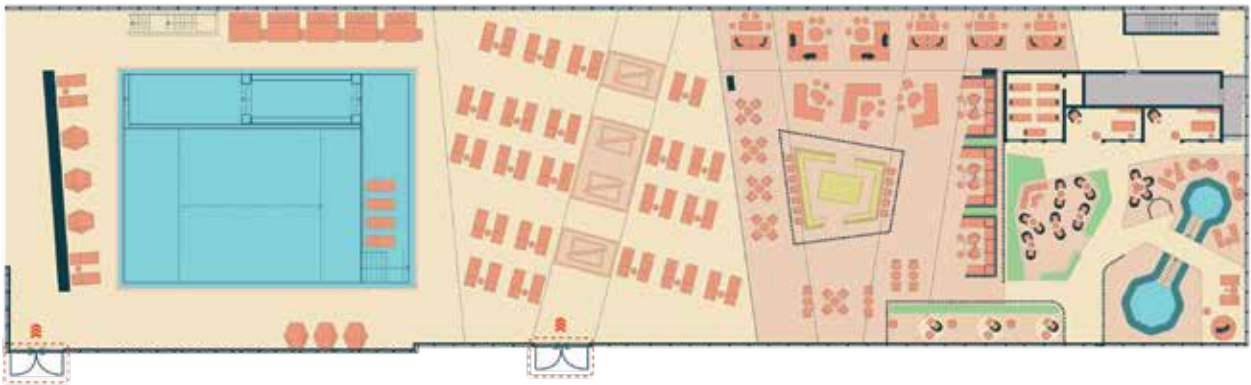

Area		Height	Lounge Seating
Sq. Ft	Sq. M		
2625	244	Open Air	90

LEGEND

Terrace 1

Greenery

Service Counter

Swimming Pool

Washroom

Back of House

Terrace 2

Bar Counter

Furniture

Water Feature

Life & Lobby

LEVEL 10 INFINITY POOL DECK

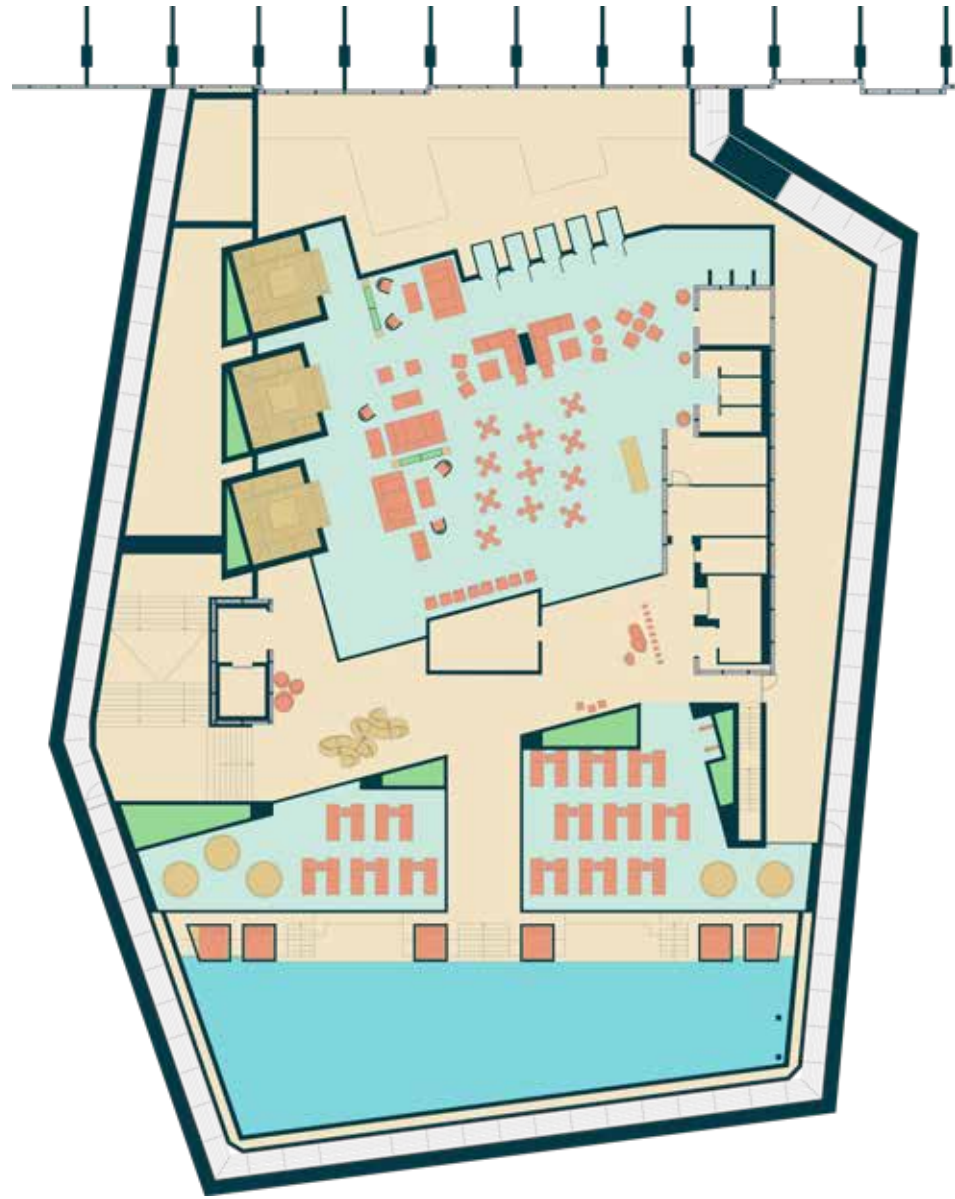

Area		Height	Lounge Seating
Sq. Ft	Sq. M	Open Air	161
10,116	940		

LEGEND

- | | | | | | |
|-----------|-------------|-----------------|---------------|--------------|---------------|
| Terrace 1 | Greenery | Service Counter | Swimming Pool | Washroom | Back of House |
| Terrace 2 | Bar Counter | Furniture | Water Feature | Life & Lobby | |



ALL DAY DINING RESTAURANT

The All Day Dining Restaurant at Cinnamon Life offers a comprehensive dining experience that caters to a diverse array of culinary preferences. With a seating capacity of 336 indoors and 236 outdoors, it accommodates large groups comfortably. The restaurant's design seamlessly blends elegance and functionality, making it suitable for both formal and informal gatherings. Operating 24/7, the restaurant features vibrant show kitchens where chefs prepare delicious dishes from around the world, providing an interactive and lively dining atmosphere.

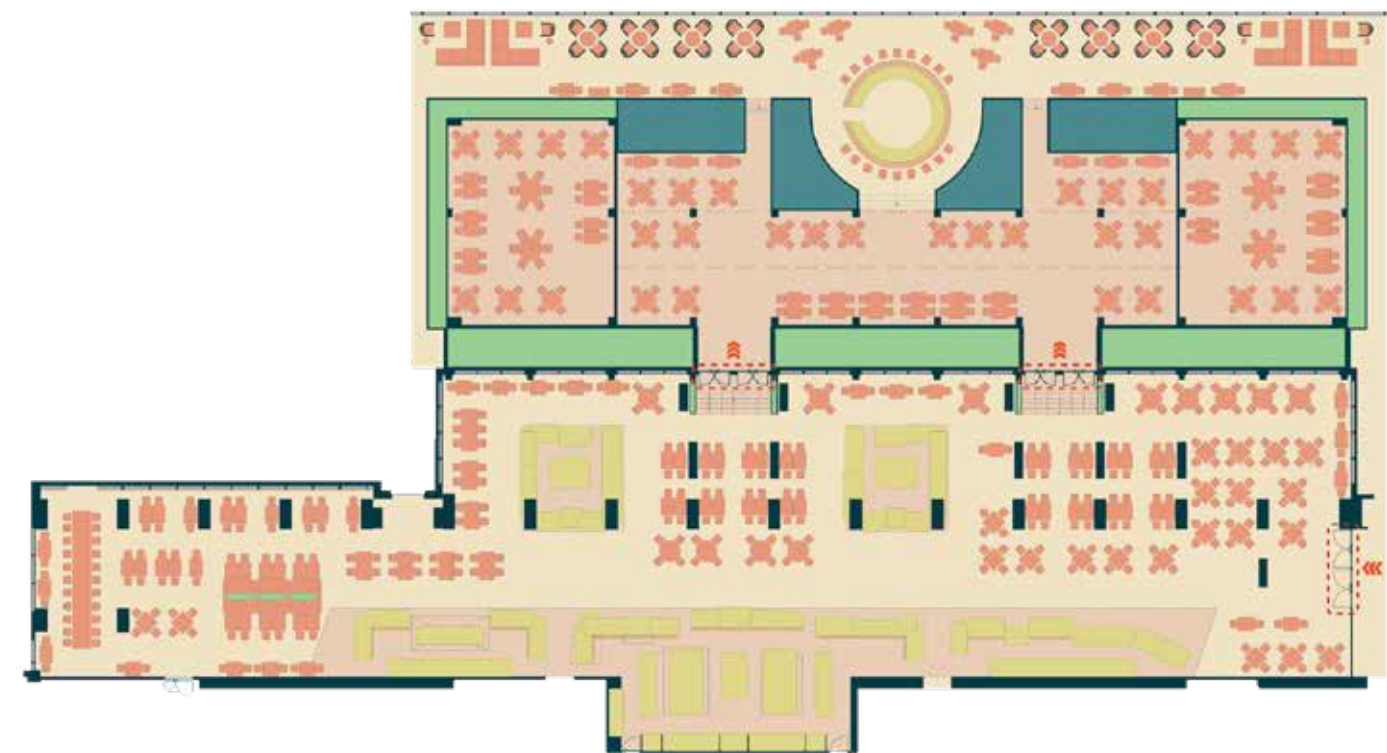

Level 09		
Indoor Seating	Seats - 336	Sq. Ft - 12,500
Outdoor Seating	Seats - 236	Sq. Ft - 18,245

LEGEND

Terrace 1

Terrace 2

Greenery

Bar Counter

Service Counter

Furniture

Swimming Pool

Water Feature

Washroom

Life & Lobby

Back of House



GASTRONOMIC EXPERIENCES AWAIT

An exclusive collection of restaurants and bars push the envelope of gastronomy with unique ambiances that let you craft your own culinary journey. Indulge in a classical high tea within a 1920's inspired lounge, a contemporary take on Indian street food, charming southern French bistro dishes, or an array of other inviting choices that serve up authentic cuisine.

RESTAURANTS, BARS & LOUNGES	LEVEL	CAPACITY	VIEW
All Day Dining	09	572	City
Indian	23	80	Ocean
Japanese	23	86	City
French Bistro	23	77	City
American Bar & Grill	23	65	Ocean
Chinese	24	139	Ocean
Wine Bar	23	69	City
Champagne, Cocktail Bar & Lounge	23 & 24	145	Ocean
Pool Bar	09	197	City
Infinity Pool Lounge	10	161	Ocean
Sky Lounge	24	106	Ocean
Chocolate Lounge	24	31	Ocean
24 Hour In Room Dining	09		





TECHNICAL SPECIFICATIONS

Stage Constructions	38 blocks (96x72 inches)
Changing Rooms	2 rooms
Floor Strength	500kg/m2
Floor Type	Concrete underlay, and carpet covering
Dance Floor	182 blocks (35x35 inches)
Public Access	Elevators from level 1 - 8
	10 elevators level 1- 22
	Capacity at 1800 kg each
	1 escalator connecting level 1 & level 2
	1 escalator connecting level 7 & level 8
Service Access	2 service elevator capacity at 2000 kg each
	Door size: 1300 x 2474 MM
	Cabin size: 1500 x 2700 x 2700 MM
	Shaft size: 5600 x 3200 MM
	PIT: 3100 MM
Power Supply	230V single phase & 460V three phase electricity
Visual Facilities	In built motorised screens and projectors available at each venue
Audio Facility	Portable and wireless microphones
Communication System	PA-LAN system
	CCTV system
Internet Access	High speed wired and wireless internet
Service Facilities	Digital signage
	Registration counter level 7
	Secretariat room
	Crew room

STAY CONNECTED



Cinnamon Life at City of Dreams Sri Lanka, No. 01, Justice Akbar Mawatha, Colombo 02

+94 (0) 112 220 000 | hello@cinnamonhotels.com | cinnamonlife.com

